

Magnetostrictive level transmitter

High-resolution measurement principle, compact design

Model FLM-CA

WIKA data sheet LM 20.04



for further approvals
see page 2



Applications

High-accuracy level detection for liquid media

Special features

- Compact and space-saving design
- Output signal 4 ... 20 mA (NAMUR NE43) or HART® ver. 6
- Operating limits:
 - Operating temperature: $T = -40 \dots +250 \text{ }^{\circ}\text{C}$
 - Operating pressure: $P = \text{Vacuum to } 40 \text{ bar}$
 - Limit density: $\rho \geq 580 \text{ kg/m}^3$
- Explosion-protected version (option)
- Vibration resistant version (option)

Description

The model FLM-CA magnetostrictive level transmitter is used for the high-accuracy, continuous level detection of liquids and is based on determining the position of a magnetic float according to the magnetostrictive measurement principle.

The FLM-CA emits a 4 ... 20 mA output signal, which is configured via buttons within the probe head. Optionally, the FLM-CA is also available with HART® protocol as a digital output signal. Probe lengths of 100 mm to 3 m and also various temperature and pressure ranges are possible.

In comparison to the FLM-S, the FLM-CA is particularly notable for its very compact and space-saving design. In addition, it can be used in applications with vibrations up to 4 g.







Fig. left: Mounting thread, cylinder float from stainless steel

Fig. right: Mounting flange, sphere float from stainless steel

Model overview

Model	Description
FLM-CA	Standard version
FLM-CAI	Explosion-protected version

Approvals

Logo	Description	Country
 	EU declaration of conformity <ul style="list-style-type: none"> ■ EMC directive EN 61326 emission (group 1, class B) and immunity (industrial application) ■ RoHS directive ■ ATEX directive (option - only with model FLM-CAI) Hazardous areas <ul style="list-style-type: none"> - Ex i II 1G Ex ia IIC T6 ... T4 Ga II 1/2G Ex ia IIC T6 ... T4 Ga/Gb II 2G Ex ia IIC T6 ... T4 Gb II 1D Ex ia IIIC T160 °C Da 	European Union
 	IECEx (option) Hazardous areas <ul style="list-style-type: none"> - Ex i Ex ia IIC T6 ... T4 Ga Ex ia IIC T6 ... T4 Ga/Gb Ex ia IIC T6 ... T4 Gb Ex ia IIIC T160 °C Da 	International

Manufacturer's information and certificates

Logo	Description
	SIL 2 Functional safety

Approvals and certificates, see website

Specifications

Magnetostrictive level transmitter, models FLM-CA, FLM-CAI	
Guide tube	<ul style="list-style-type: none"> ■ Ø 6 mm (max. 1,000 mm) ■ Ø 12 mm (max. 3,000 mm)
Process connection	Mounting thread downwards <ul style="list-style-type: none"> ■ G 1/2" ... G 2" ■ NPT 1/2" ... NPT 2" Mounting flange <ul style="list-style-type: none"> ■ ANSI 1/2" ... 2 1/2", class 150 ... 600 ■ EN DN 20 ... DN 65, PN 6 ... PN 100 ■ DIN DN 20 ... DN 65, PN 6 ... PN 100 Other process connections on request

Magnetostrictive level transmitter, models FLM-CA, FLM-CAI

Materials	
Wetted parts	Stainless steel 1.4571 (316Ti)
Connection head	Stainless steel 1.4305 (303)
Insertion length	
Guide tube Ø 6 mm	100 ... 1,000 mm
Guide tube Ø 12 mm	100 ... 3,000 mm
Measurement accuracy	±1.25 mm
Resolution	0.1 mm
Electrical connection	Connection terminals max. 1.5 mm ²
Supply voltage	DC 8 ... 30 V
Output signal	<ul style="list-style-type: none"> ■ 4 ... 20 mA (NAMUR NE43) ■ HART® ver. 6
Vibration resistant version (option)	to 4 g (only for guide tube Ø 12 mm)
Operating pressure	Depending on the float, max. 40 bar
Operating temperature	
Guide tube Ø 6 mm	-40 ... +125 °C
Guide tube Ø 12 mm	-40 ... +250 °C
Ambient temperature	-40 ... +85 °C
Ingress protection per EN 60529	IP68
Configuration	
Version without HART® protocol	Via two built-in buttons in the connection housings
Version with HART® protocol	Via two built-in buttons, HART® communicator or HART® interface in the connection housings

Float

Material	Version	Description	Suits guide tube Ø in mm	Minimum dimension U in mm	Max. operating pressure in bar	Limit density 85 % in kg/m ³
Stainless steel 1.4571 (316Ti)	V18/42A	Cylinder Ø 18 mm	6	48	6	800
	V27A	Cylinder Ø 27 mm	6	22	16	700
	V29A	Sphere Ø 29 mm	6	20	25	920
	V29A/40	Cylinder Ø 29 mm	12	26	10	620
	V44A	Cylinder Ø 44 mm	12	32	16	720
	V52A	Sphere Ø 52 mm	12	32	40	690
Titanium 3.7035 (Grade 2)	T29A	Sphere Ø 29 mm	6	21	30	700
Buna (NBR)	B18A	Cylinder Ø 18 mm	6	38	3	620
	B20A	Cylinder Ø 20 mm	6	26	3	940
	B23A	Cylinder Ø 23 mm	6	31	6	800
	B25A	Cylinder Ø 25 mm	6	20	3	790
	B30A	Cylinder Ø 30 mm	6	51	3	680
	B40A	Cylinder Ø 40 mm	12	36	3	580

Dimensions in mm

Read-out unit

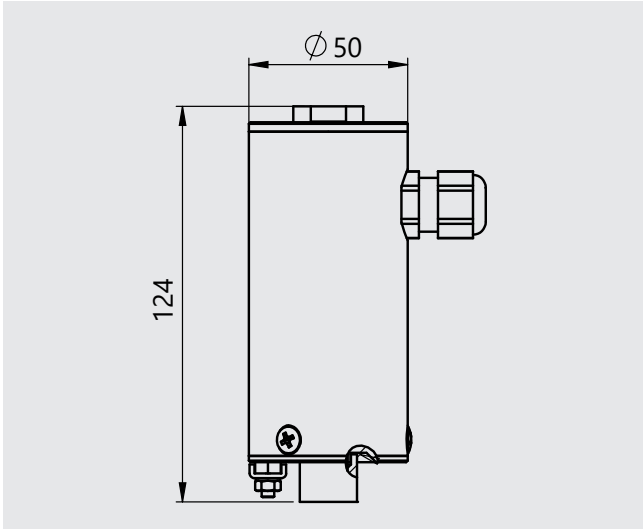

Sensor unit

Mounting thread

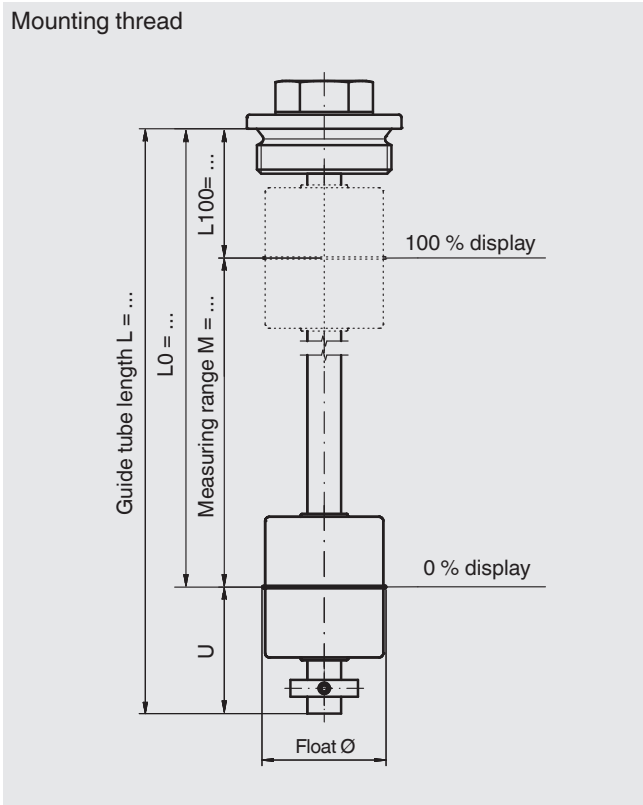

Mounting flange

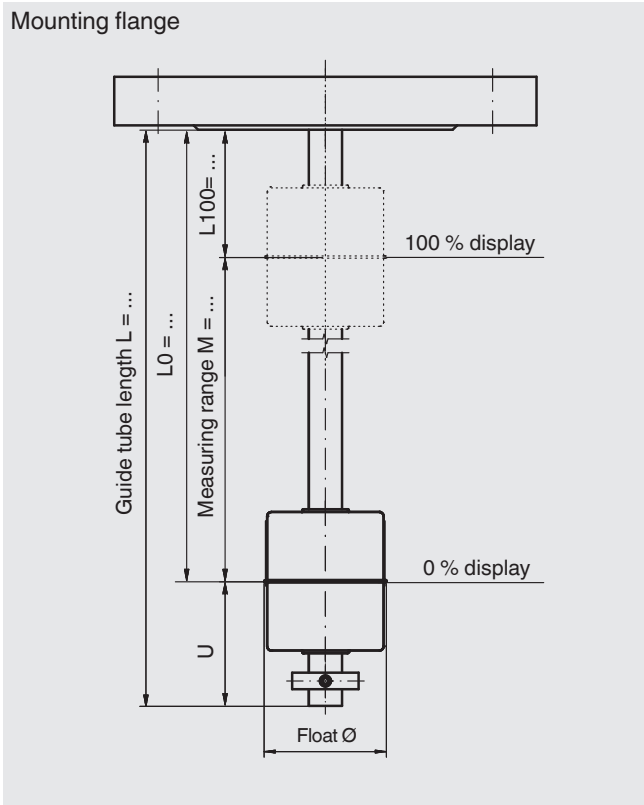

Ordering information

Model / Version / Electrical connection / Process connection / Guide tube diameter / Guide tube length (insertion length) L / 100 % mark L1 / Measuring range M (span 0 ... 100 %) / Process specifications (operating temperature and pressure, limit density) / Options

© 03/2020 WIKA Alexander Wiegand SE & Co. KG, all rights reserved.
The specifications given in this document represent the state of engineering at the time of publishing.
We reserve the right to make modifications to the specifications and materials.



WIKA Alexander Wiegand SE & Co. KG
Alexander-Wiegand-Straße 30
63911 Klingenberg/Germany
Tel. +49 9372 132-0
Fax +49 9372 132-406
info@wika.de
www.wika.de